

# TEST WALL 3 FORMWORK ASSEMBLY BOOKLET

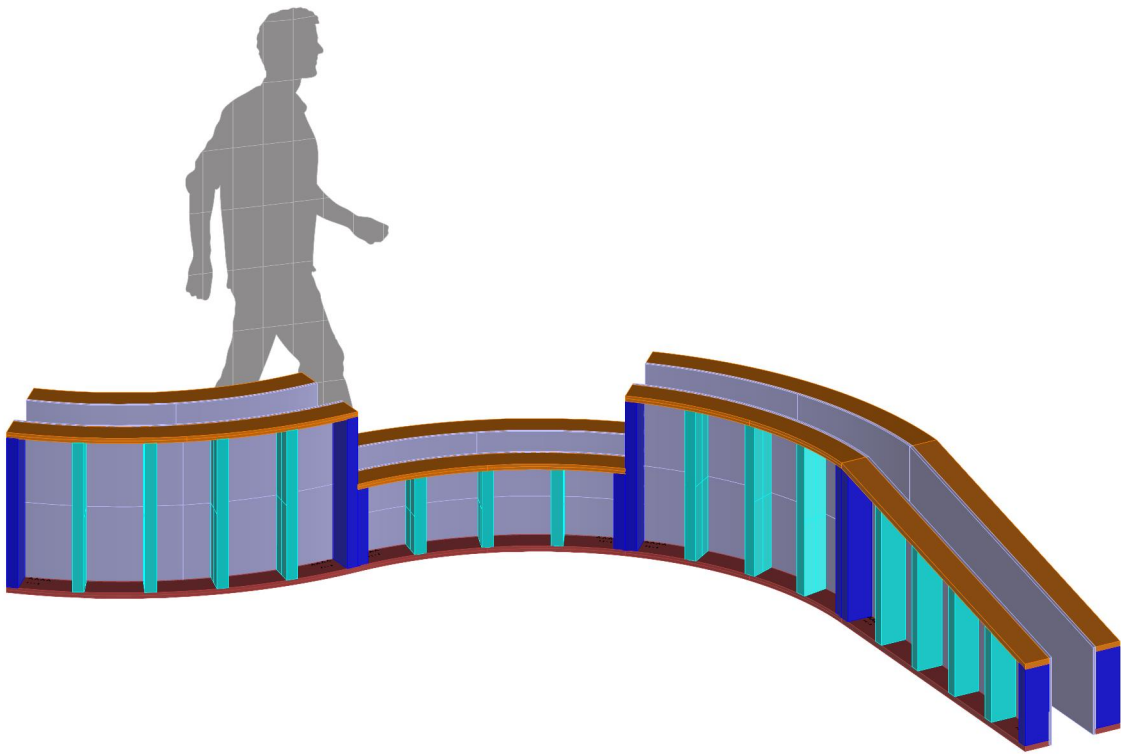



HOW TO USE THIS MANUAL

STEP-BY-STEP ILLUSTRATIONS



THIS MANUAL ILLUSTRATES THE ASSEMBLY PROCESSES FOR THE PREFABRICATED FORMWORK DESIGN PICTURED.

THE PANELS ARE GROUPED INTO DIFFERENT PAGE SPREADS BASED ON TYPE AND SIMILARITY.

AFTER ALL PANELS HAVE BEEN BUILT, THE MANUAL WILL COVER BROADER LAYOUT AND ASSEMBLY OF THE ENTIRE FORMWORK WALL.

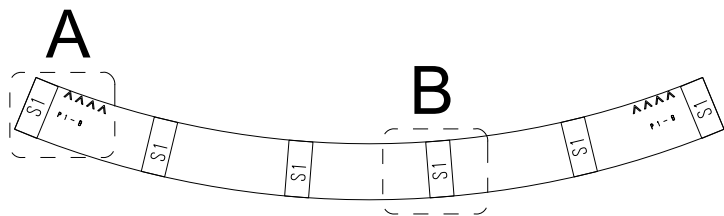

READING PLATE LABELS

EACH TOP AND BOTTOM PLATE HAS A SERIES OF LABELS ON IT TO MAKE IDENTIFICATION AND ASSEMBLY EASIER.

A

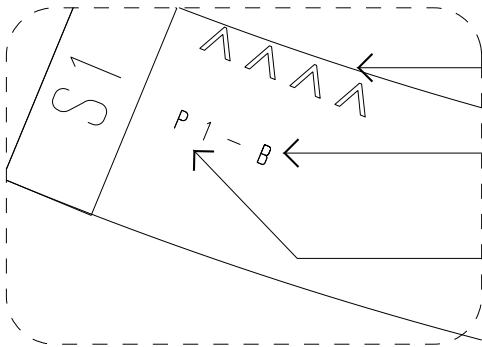

THESE ARROWS INDICATE THE SIDE RECEIVING THE CASTING FACE

THIS PART OF THE CODE INDICATES IF IT IS A TOP OR BOTTOM PLATE

THIS PART OF THE CODE INDICATES THE PANEL NUMBER

B

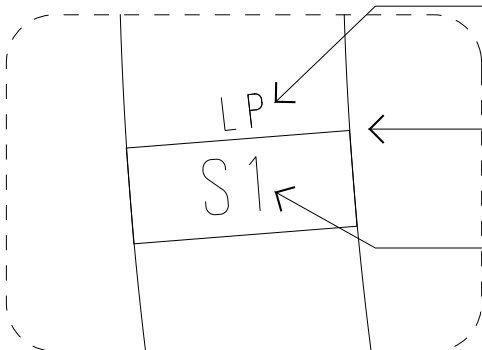

FOR A PANEL WITH A SLOPING PLATE, THIS INDICATES WHERE THE LONGER SIDE OF THE STUD SHOULD GO

STUDS SHOULD BE POSITIONED TO FIT WITHIN THESE LINES

THIS CODE INDICATES WHICH STUD TO PLACE HERE; REFERENCE THE BILL OF MATERIALS FOR THE DIMENSIONS TIED TO THE CODE

# 1 MATERIALS CHECKLIST

## 2 PANEL FRAMING (P1 EXAMPLE)

FLIP SO LABELS FACE STUDS

P1-T

x6 - S1

P1-B

S1

ALIGN STUD BETWEEN SCRIBED LINES

## CASTING FACE ATTACHMENT 3

ATTACH CASTING FACE WITH  
FASTENERS TO THE FRAMING  
BEYOND, MINIMUM 2 PER STUD

FOR TALLER PANELS P1, P3, P6,  
P8, ADD A FASTENER IN THE  
CENTER OF THE STUD AS  
SHOWN IN GRAY

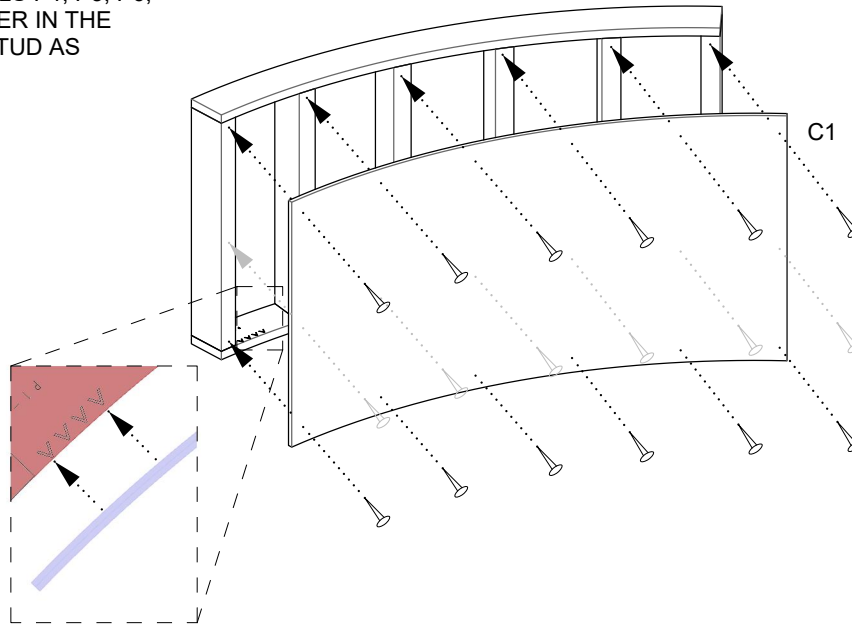

## COMPLETE PANEL 4

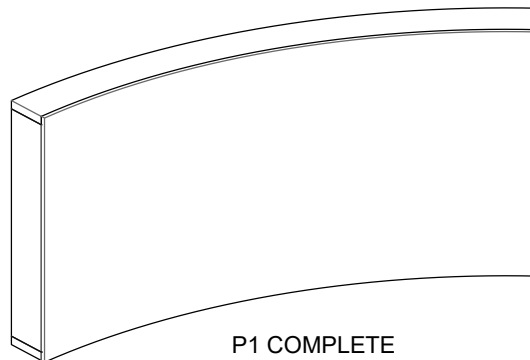

REPEAT STEPS 2-4  
FOR REMAINING  
STANDARD PANELS

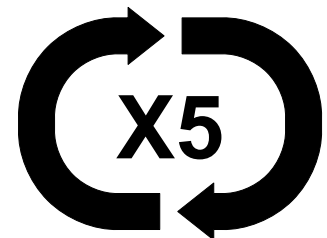

5 MATERIALS CHECKLIST

BILL OF MATERIALS		
CT	CODE	DESC.
1	P4-T	P4 TOP PLATE
1	P5-T	P5 TOP PLATE
1	P4-B	P4 BOT. PLATE
1	P5-B	P5 BOT. PLATE
2	S3	2X4; 20-1/2" 77° TOP CUT
2	S4	2X4; 18-5/8" 77° TOP CUT
2	S5	2X4; 16-5/8" 77° TOP CUT
2	S6	2X4; 14-5/8" 77° TOP CUT
2	S7	2X4; 12-5/8" 77° TOP CUT
2	S8	2X4; 10-7/8" 77° TOP CUT
1	C4	3'-9" X 1'-10" SLOPING TO 1'-0"
1	C5	3'-9" X 1'-10" SLOPING TO 1'-0"

6 PANEL FRAMING (P4 EXAMPLE)

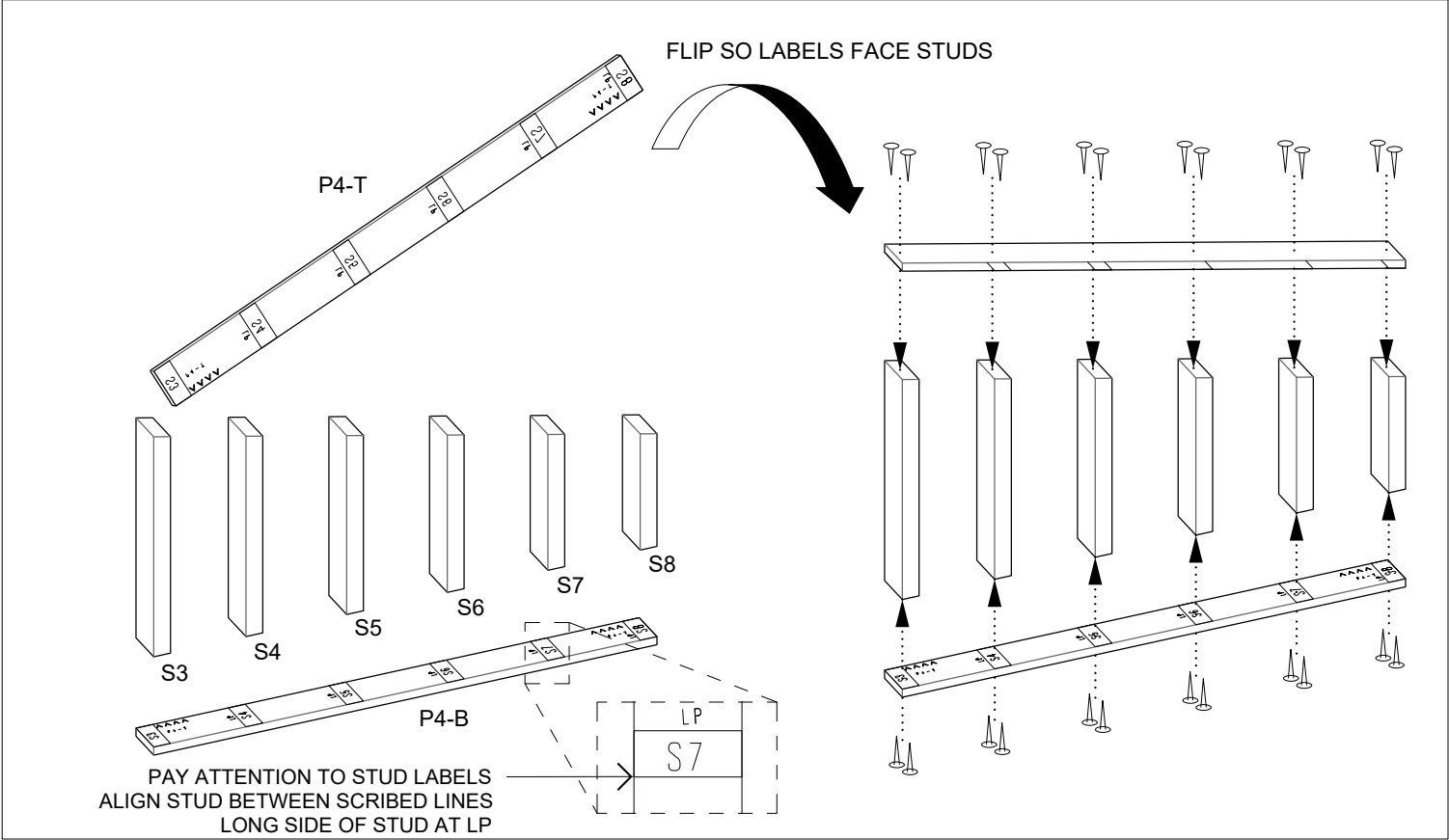

## CASTING FACE ATTACHMENT 7

ATTACH CASTING FACE WITH  
FASTENERS TO THE FRAMING  
BEYOND, MINIMUM 3 PER STUD

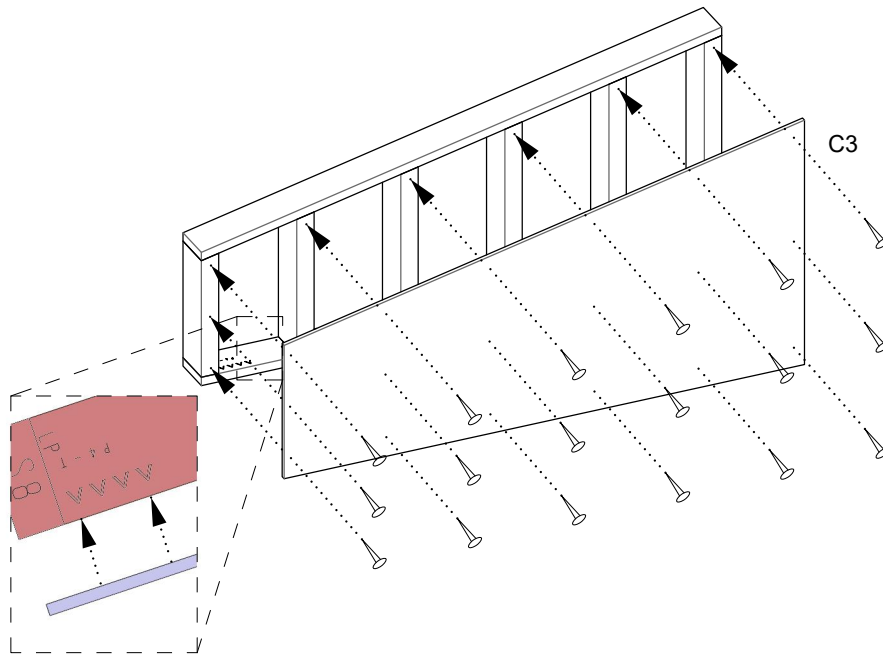

## COMPLETE PANEL 8

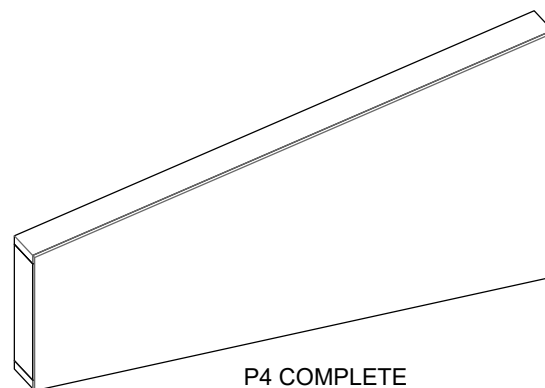

REPEAT STEPS 6-8  
FOR REMAINING  
SLOPING PANELS

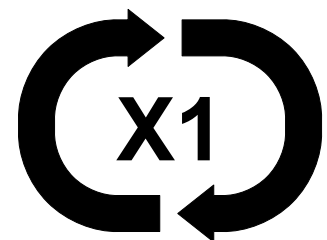

9 FORMWORK WALL P1-P4

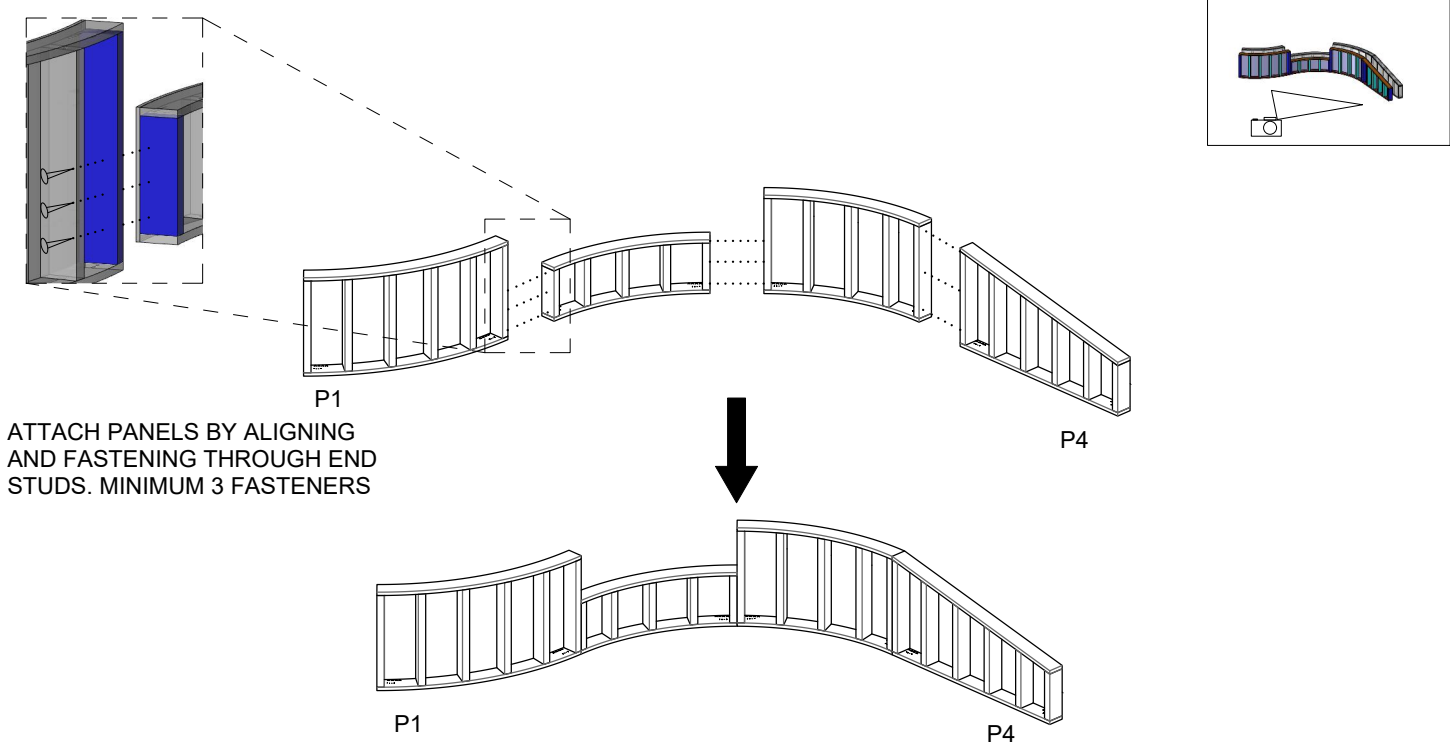

10 FORMWORK WALL P5-P8

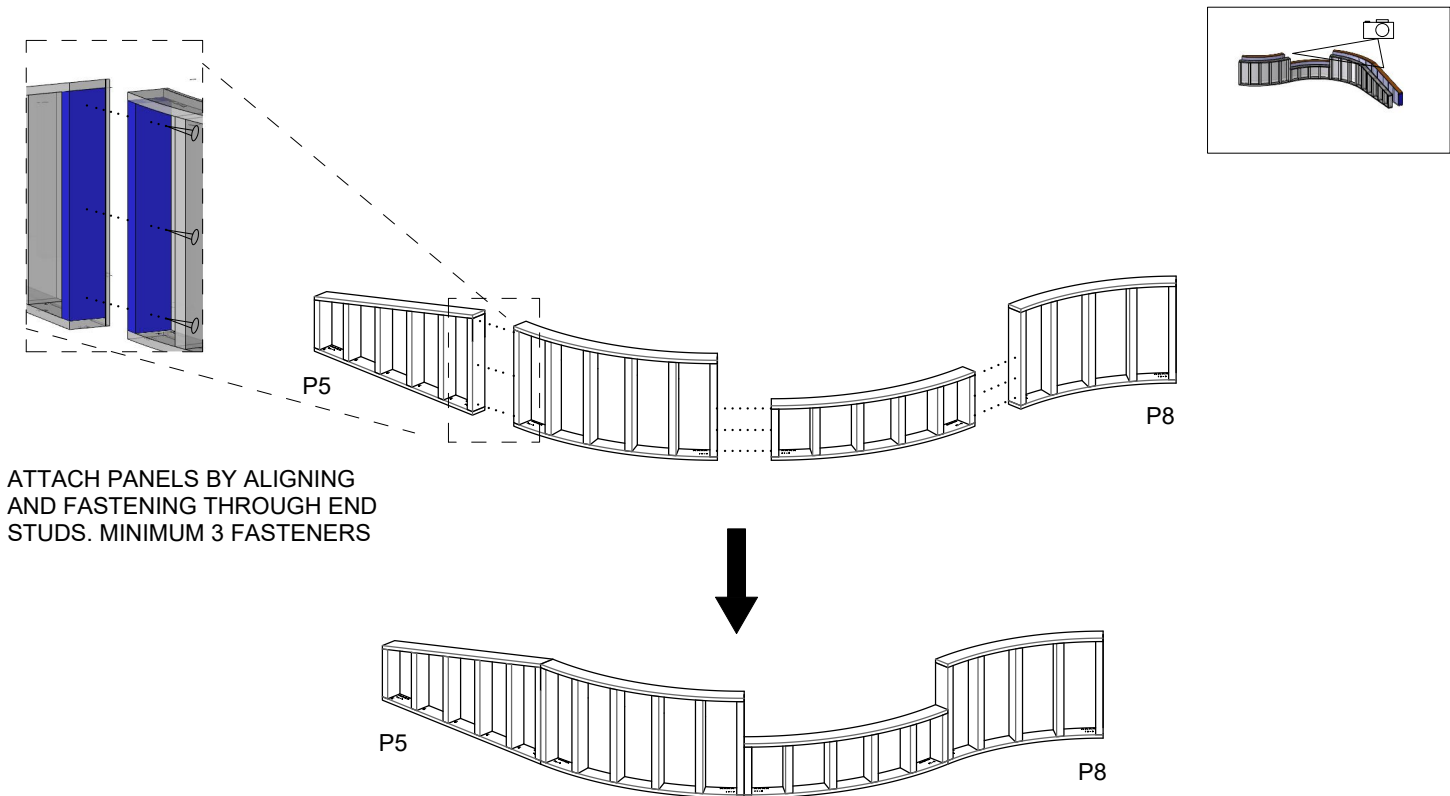



LAYOUT PLAN 11

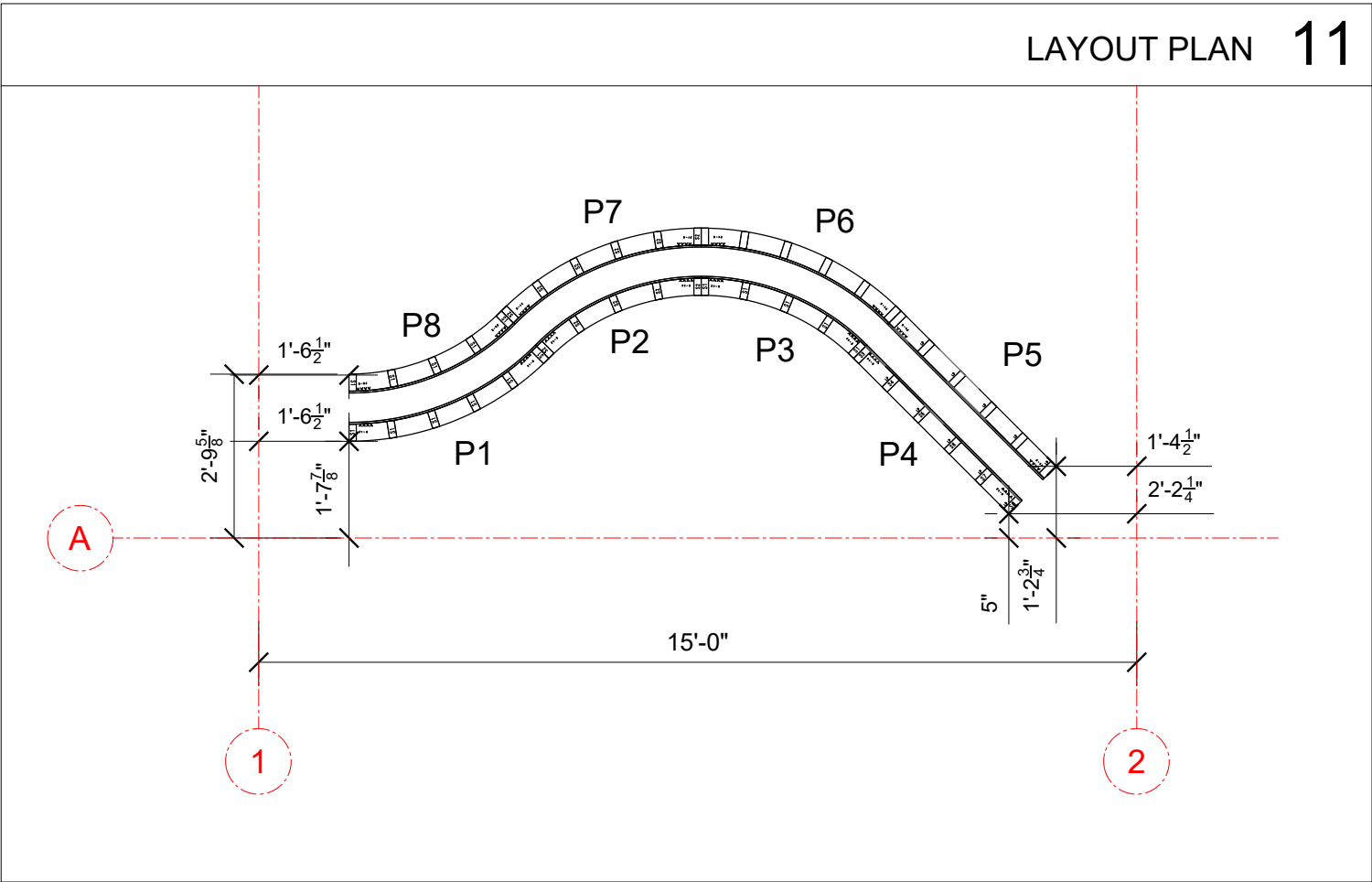

COMPLETED FORMWORK SYSTEM 12

